

Luxmeter LX 100



Technical features

Measuring range.....	from 0,1 to 150 000 Lux from 0.01 to 13940 fc
Spectral response.....	as per standard photopic curve V(λ) NF C 42 -710 class C.
Error limit V(λ) (f1)	< 10%
True cosine evaluation (f2).....	< 6%
Linearity (f3).....	< 3%
Measurement capability.....	3 days – 03D00H00M
Display.....	Backlit LCD graphic 128x64.
Working temperature.....	from 0°C to +50°C
Storage temperature.....	from 0°C to +50°C
Housing dimensions (without sensor)....	120x58x34 mm
Weight (housing+sensor+battery).....	185 gr
Digital electronic.....	low drift
Mini-USB plug.....	for USB power supply adaptor
Power supply.....	3 batteries 1.5V type LR3-AAA
Battery life.....	72 hours min, continuous operation.
Electromagnetic compatibility.....	according to 89/336/CEE
Conformity.....	as per RoHS

Illuminance measuring range

- ♦ from 0,1 to 150 000 Lux

Display	Unit	Resolution	Accuracy
0.1 to 10.0	lx	0.1	0.1 lux
10.0 to 99.9	lx	0.1	1%
100.0 to 999.9	lx	0.1	1%
1000 to 9999	lx	1	1%
10.00 to 99.99	klx	10	1%
100.0 to 150.0	klx	100	1%

- ♦ from 0 to 13940 fc

Affichage	Unité	Résolution	Précision
0.00 to 1.00	fc	0.01	0.01 fc
1.00 to 99.99	fc	0.01	1%
100.0 to 999.9	fc	0.1	1%
1000 to 9999	fc	1	1%
10.00 to 13.94	kfc	10	1%



LX100 hand-held luxmeter, self-contained and automatic is specially designed to illuminance measurement.

Sensing element in silicon photodiode, with spectral responsivity in accordance with photonic curve (CIE).

Illuminance measurement in lux or in foot-candelas for illuminance levels below 10 lux, with 0,1 lux calculation accuracy and with 1% accuracy beyond until 150000 lux.

Instantaneous measurement, display illuminance for local measurements.

With timed measurement :

- Illuminance min/max values display
- Illuminance averaged value calculation

With relative illuminance function :

- allows a relative measurement to a reference point for the quantification of a luminous contribution or an illuminance decrease.

With hold function :

- Allows to avoid illuminance noise or to save on screen local measurement.

Measurement saving when unexpected power cut occurs.

■ Presentation

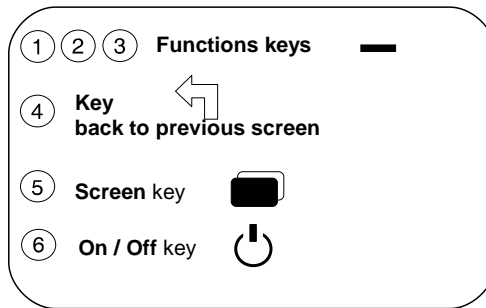

Settings

Configurable, **LX100** allows :

Contrast and backlight settings



Select language (french or english) and measuring units (lux or fc)

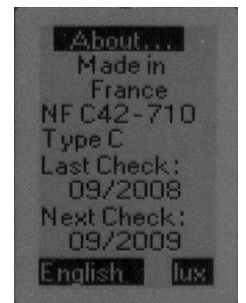

Measurement

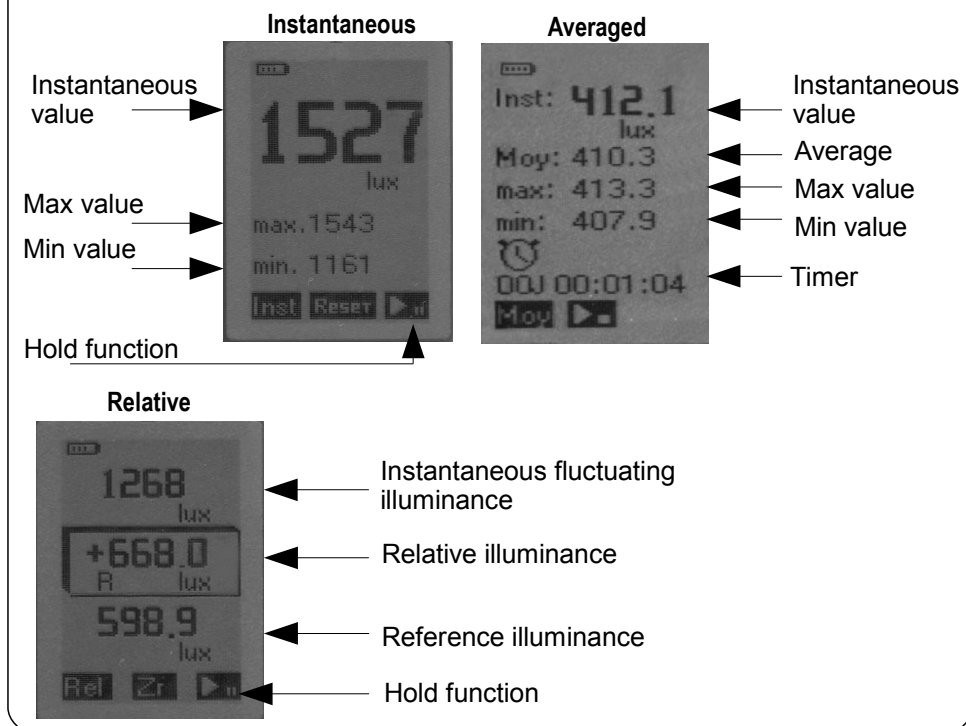

■ Supplied with ...

- **LX100** housing with silicon photodiode sensor and glass filter correction.
- Transport case
- 3 batteries LR3-AAA
- Calibration certificate
- **LX100** user manual